

IF SELF TAPPING SCREWS
PENETRATE WEATHER
BARRIER, THESE LOCATIONS
MUST BE SEALED

#10 X 3/8" SELF TAPPING
SCREWS MAY BE USED WITH
EXTERIOR INSULATED WALLS

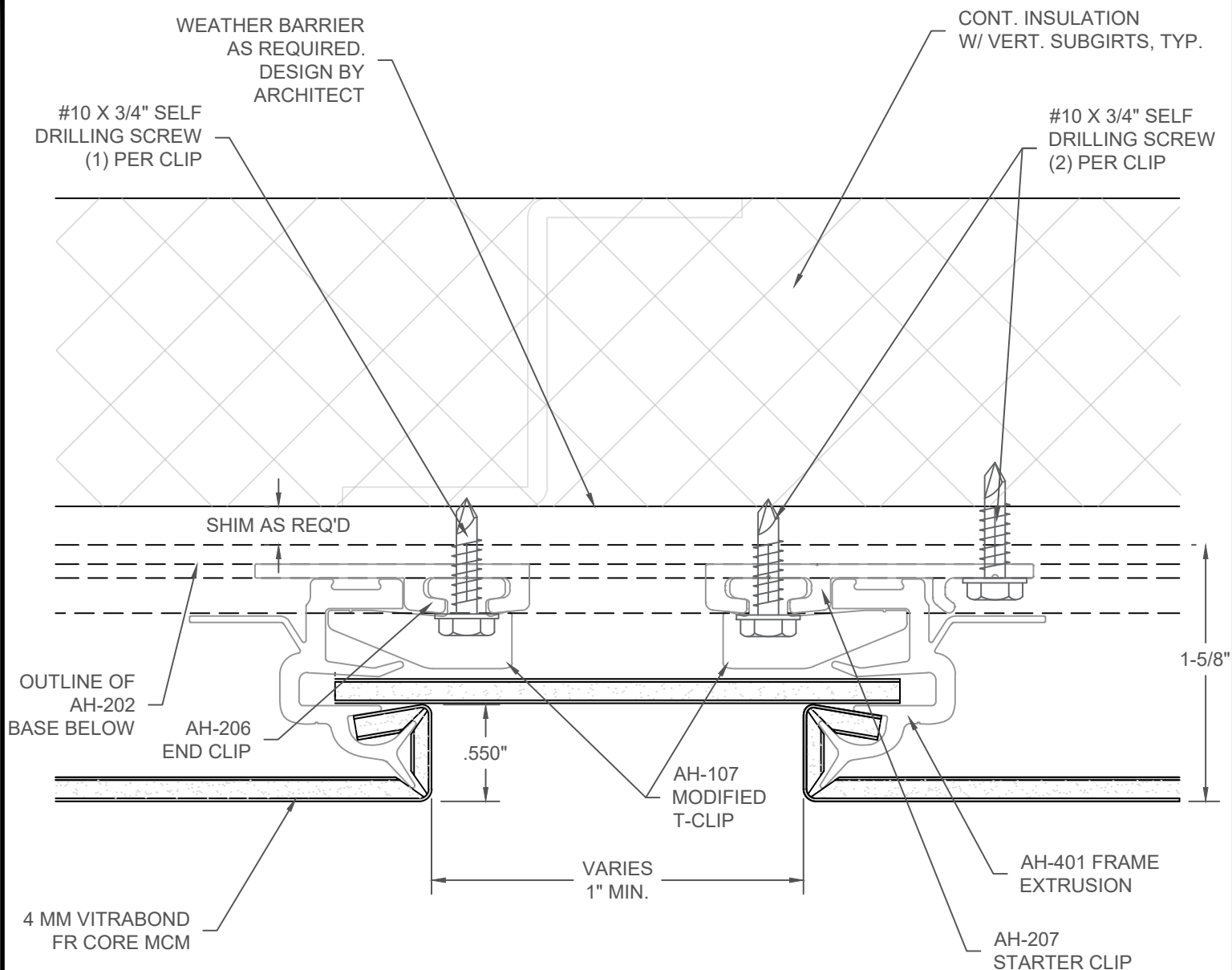

Sheet

5B

Drawn By
JSJ

Date Drawn
10/03/18

Revisions

No. Date

No. Date

Project Number

DWG-01

Project

ARROWHEAD LEAN ALT. VERTICAL DETAIL GRID INSTALLATION

© Copyright Fairview Architectural LLC - Patented and/or Patent Pending

FAIRVIEW
ARCHITECTURAL
arrowhead
ARCHITECTURAL PANEL SYSTEMS

www.fairview-na.com